

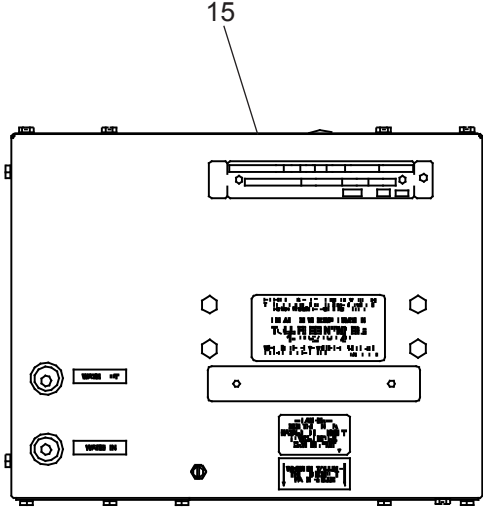

قائمة مفصلة لقطع الغيار 220 فولت - 60 هرتز

| الوصف   | رقم القطعة | رقم العنصر |
|---|------------|------------|
| طقم - مجموعة استبدال جهاز تبخير كابينية                         | 0000000886 | 1          |
| 28478C  |            | 2          |
| طقم - مكثف/مجفف   | 98776C     | 3          |
| طقم - محرك مروحة/ريشة مروحة/صمامولة/بدون غطاء (60 هرتز)         | 0000000245 | 4          |
| كتيفة - تثبيت المروحة   | 20282C     | 5          |
| طقم - جهاز توزيع الحرارة/مجفف                                   | 98778C     | 6          |
| 66703C  |            | 7          |
| مجموعة صيانة الضاغط (60 هرتز)                                   | 1000002146 | 8*         |
| طقم - المسامير/التحكم في التبريد                                | 98773C     | 9          |
| اللوحة - الأمامية   | 28477C     | 10         |
| طقم - التركيبات الكهربائية/المرحل/الغطاء/الحمل الزائد (60 هرتز) | 98752C     | 11         |
| 98777C  |            | 12         |
| طقم - جهاز تثبيت الضاغط   | 98777C     | 12         |
| ممتص الصدمات  | 50930C     | 13         |
| صفحة قاعدية   | 27303C     | 14         |
| اللوحة - الخلفية  | 22300C     | 15         |
| مصفاة الخط  | 55996C     | 16         |
| غطاء  | 56237C     | 17         |



\*يشمل المرحل والحمل الزائد. إذا كان مشمولاً بالضمان، استبدله بضاغط مماثل مستخدم بمجموعة أصلية.  
ملاحظة: يجب أن تتضمن كل الوثائق التي تتعلق بأي من مبردات المياه أو طلبات لقطع غيار أعلاه رقم الطراز والرقم التسلسلي للمبرد، واسم ورقم قطعة الغيار.

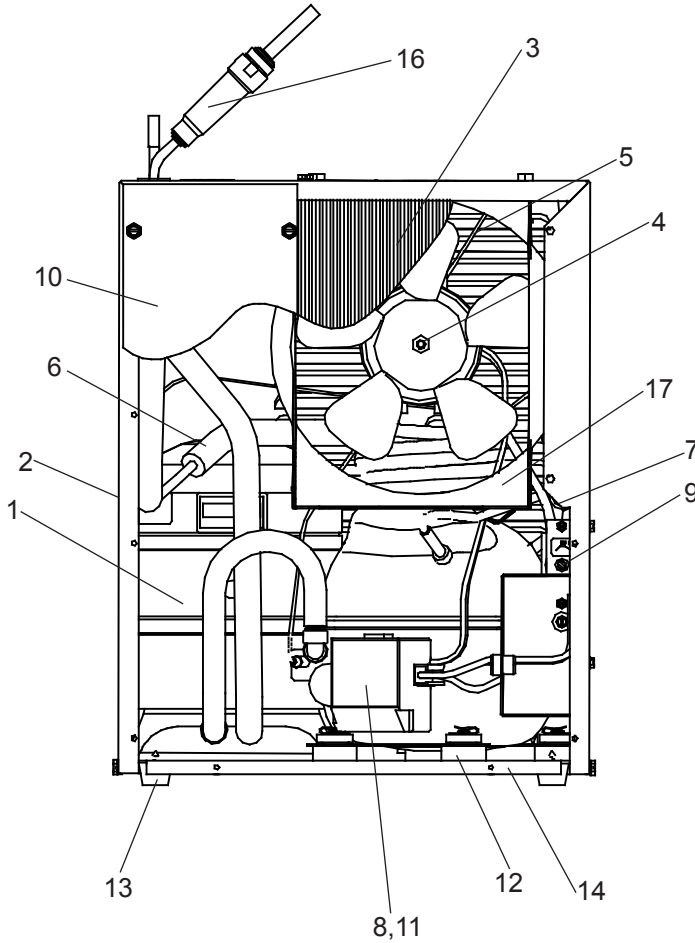

مخطط توصيلات الأسلاك

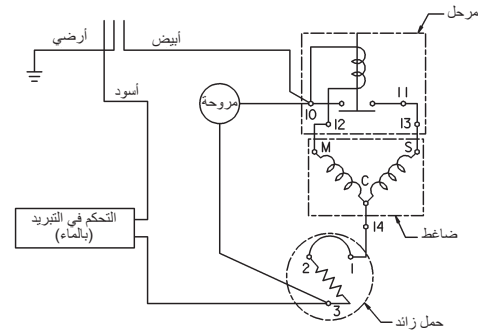

الرقم المجاني لمعلومات خدمة الإصلاح هو 1.800.260.6640

للحصول على قطع الغيار، اتصل على الموزع المحلي أو اتصل على الرقم 1.800.834.4816

ELKAY MANUFACTURING COMPANY • 2222 CAMDEN COURT • OAK BROOK, IL 60523 • 630.574.8484

تُصنع في الولايات المتحدة الأمريكية.

220V-60Hz ITEMIZED PARTS LIST

| ITEM NO. | PART NO.   | DESCRIPTION                                      |
|----------|------------|--|
| 1        | 98724C     | KIT - EVAPORATOR REPLACEMENT ASSEMBLY            |
| 2        | 28478C     | CABINET  |
| 3        | 98776C     | KIT - CONDENSER/DRIER                            |
| 4        | 0000000245 | KIT - FAN MOTOR/BLADE/NUT/WITHOUT SHROUD (60 HZ) |
| 5        | 20282C     | BRACKET - FAN MOUNTING                           |
| 6        | 98778C     | KIT - HEAT EXCHANGER/DRIER                       |
| 7        | 66703C     | DRIER  |
| *8       | 1000002146 | COMPRESSOR SERVICE PAK (60 HZ)                   |
| 9        | 98773C     | KIT - COLD CONTROL/SCREWS                        |
| 10       | 28477C     | PANEL - FRONT                                    |
| 11       | 98752C     | KIT - ELECTRICAL/RELAY/COVER/OVERLOAD (60 HZ)    |
| 12       | 98777C     | KIT - COMPRESSOR MOUNTING HARDWARE               |
| 13       | 50930C     | BUMPER   |
| 14       | 27303C     | BASEPLATE  |
| 15       | 22300C     | PANEL - REAR                                     |
| 16       | 55996C     | IN-LINE STRAINER                                 |
| 17       | 56237C     | SHROUD   |

**\*INCLUDES RELAY & OVERLOAD. IF UNDER WARRANTY, REPLACE WITH SAME COMPRESSOR USED IN ORIGINAL ASSEMBLY.**

NOTE: All correspondence pertaining to any of the above water cooler or orders for repair parts MUST include model number and serial number of cooler, name and part number of replacement part.

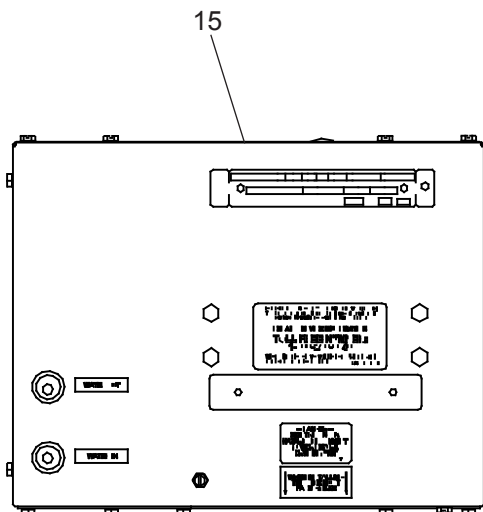

WIRING DIAGRAM

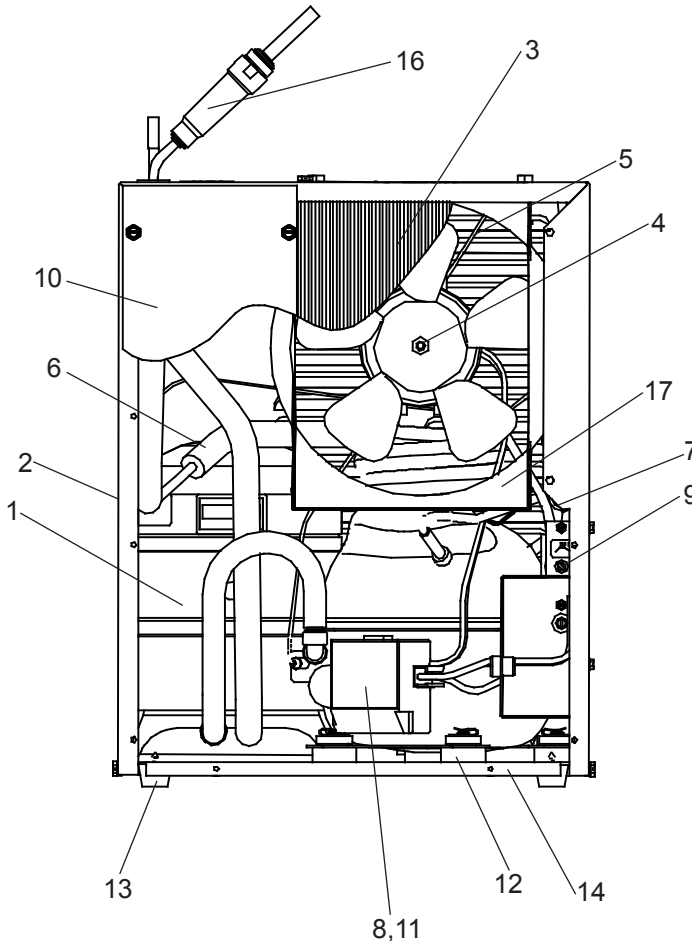
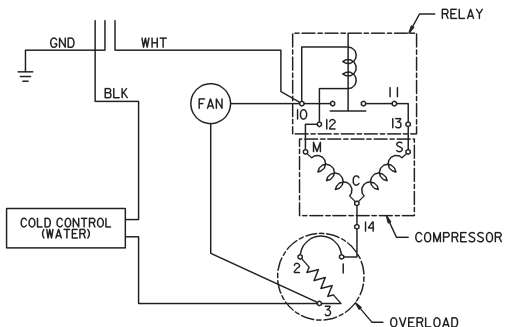

REPAIR SERVICE INFORMATION TOLL FREE NUMBER 1.800.260.6640

FOR PARTS, CONTACT YOUR LOCAL DISTRIBUTOR OR CALL 1.800.834.4816

ELKAY MANUFACTURING COMPANY • 2222 CAMDEN COURT • OAK BROOK, IL 60523 • 630.574.8484

# ELKAY® Remote Chiller Refrigeration Package

## INSTALLATION, CARE & USE MANUAL

### For Commercial Use Uses HFC-R134a Refrigerant

**Note: Danger! Electric shock hazard. Disconnect power before servicing unit.**

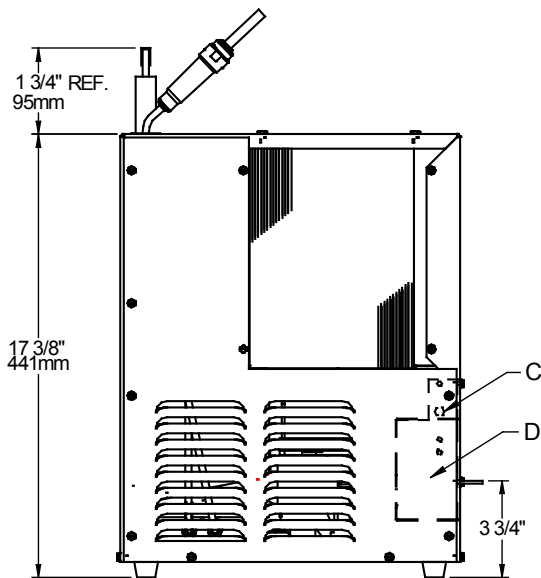
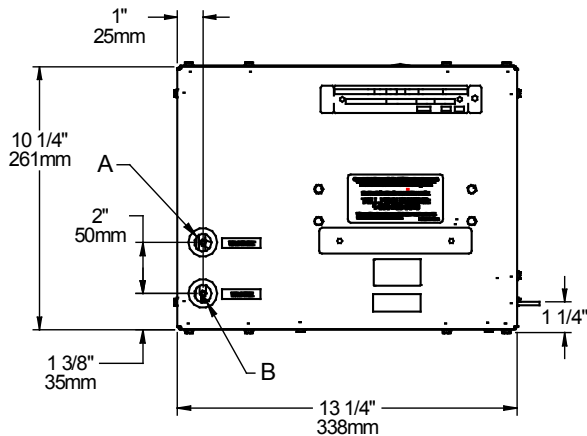

**LEGEND**  
**A = 1/4" O.D. TUBE WATER OUTLET**  
**B = 1/4" O.D. TUBE WATER INLET**  
**C = TEMPERATURE ADJUSTMENT**  
**D = ELECTRICAL**

#### WARNING

A MEANS FOR DISCONNECTING ELECTRICAL SUPPLY POWER TO THE UNIT MUST BE INCORPORATED IN THE FIXED WIRING ACCORDING TO THE WIRING RULES. THIS IS TO ALLOW DISCONNECTION OF THE UNIT FROM THE ELECTRICAL SUPPLY AFTER INSTALLATION.

#### INSTALLATION

1. When mounting unit in an open area, to insure proper ventilation, maintain a 4" (102mm) clearance from cabinet louvers on each side of cooler. When mounting unit in a cavity or behind a wall, maintain minimum space of 4" (102mm) on each side, 4" (102mm) on the top and a depth of 12" (305mm).
2. Water inlet is 1/4" (6 mm) O.D. tube. Contractor to supply the connections as required.
3. Connecting lines to be of unplated copper, thoroughly flushed to remove all foreign matter before being connected to cooler. If flushing does not remove all particles, a water strainer should be installed in supply line. This cooler is manufactured in such a manner that it does not in any way cause taste, odor, color or sediment problems.
4. Connect cooler to building supply line with a shut-off valve and install the in-line strainer between the valve and cooler.
5. Electrical: Make sure power supply is identical in voltage, cycle, and phase to that specified on cooler serial plate. Never wire compressor directly to the power supply.
6. This chiller has been designed for use with potable water ONLY, at a supply line pressure of 20 to 100 PSI (0.14-0.69 MPa) and a maximum water temperature of 90°F (32°C).

#### START-UP

1. Open supply line valve.
2. Purge air from all water lines by operating bubbler valve of fountain to which cooler is connected. Steady stream assures all air is removed.
3. Rotate fan to insure proper clearance and free fan action.
4. Connect to electrical power.

#### TROUBLE SHOOTING & MAINTENANCE

**Temperature Control:** Factory set at 50°F (± 5°) (10°C ± 2.8°C) under normal conditions. For colder water, adjust screw on item no. 9 in clockwise direction.

**Ventilation:** Cabinet louvers and condenser fins should be periodically cleaned with brush, air hose or vacuum cleaner. Excess dirt or poor ventilation can cause no cold water and compressor cycling on the compressor overload protector.

**Lubrication:** Motors are lifetime lubricated.

**Actuation of Quick Connect Water Fittings:** Cooler is provided with lead-free connectors which utilize an o-ring seal. To remove tubing from the fittings, relieve water pressure and push in on gray collar while pulling on the tubing. To insert tubing, push tube straight into fitting until it reaches a positive stop, approximately 3/4" (19mm).

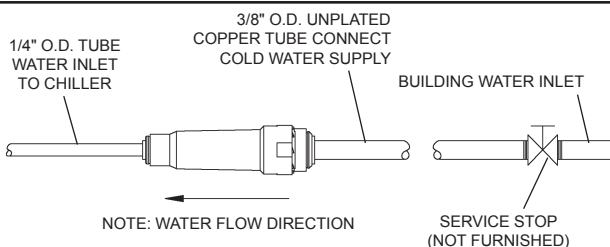

#### OPERATION OF QUICK CONNECT FITTINGS

